

### Typical Applications

- Automotive
- Instrumentation
- Industrial control
- Medical
- Military



### Switching function : off - mom

#### Specifications :

- ◆ Contact Rating :24V DC, 20mA; min. 0.5W
- ◆ Contact Resistance :<100mΩ
- ◆ Insulation Resistance :>1000MΩ at 100VDC
- ◆ Dielectric Strength:250V, 50Hz for the duration of 1 minute
- ◆ Operation Temperature :-25℃ to +85℃
- ◆ Mechancial Life :minimum 1,000,000 operations
- ◆ Push Force :4N±0.5N
- ◆ Contacts :Silver-Plated over Nickel barrier
- ◆ Terminals :PC Terminals, Gold-Plated over Nickel barrier
- ◆ Material :case : Thermoplastic, UL 94V-0, Blue (THT type), case : Thermoplastic, UL 94V-0, Black (SMD type) button : Silicon. cap : PC, UL 94V-2
- ◆ Mounting :on pc-board
- ◆ Soldering condition :auto-soldering max: 5 sec, 270℃ reflow-soldering-max : 60sec. 200℃ /max 15 sec, 260℃

### TE 1-R

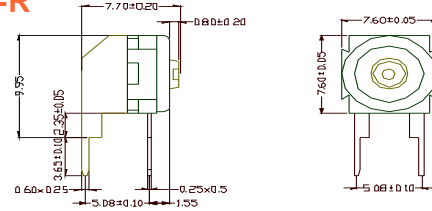

CIRCUIT DIAGRAM

DRILLING PLAN

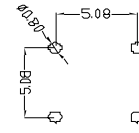
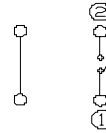

### TE 1

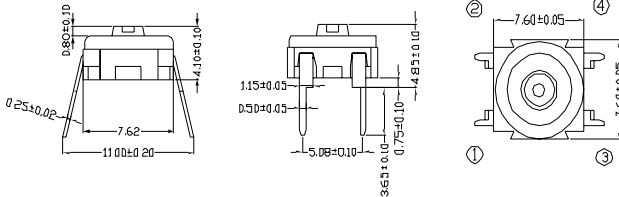

CIRCUIT DIAGRAM

DRILLING PLAN

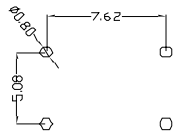
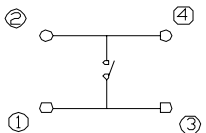

### TES1

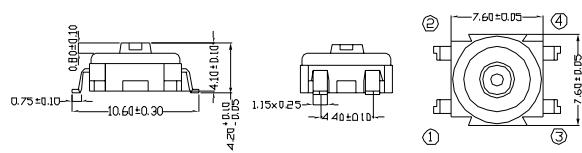

CIRCUIT DIAGRAM

SMD SOLDERING PAD

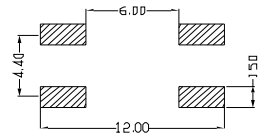
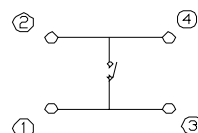

### How to order

TE1  
TE1-R  
TES1



CAP

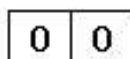

COLOR

TE1: Thru hole  
TE1-R:Right angle  
TES1:SMD

A (SQUARE)

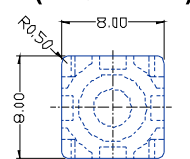

B (ROUND)

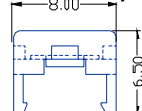

00 Grey  
01 Dark Grey  
02 Black  
03 Red

### TE Typical system assembly with plunger under overlay

Solder terminal for PCB.

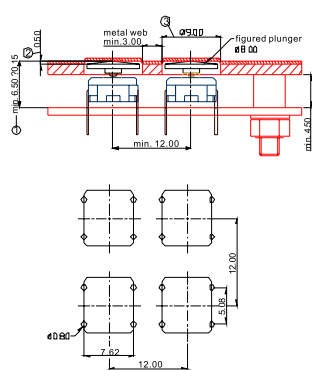

SMD gullwing terminal

